

NOTE -
DESIGNED FOR BENDING FIBER STRESS
OF 1200 P.S.I. IN TIMBERS,
AND JOISTS OF 85 MPH WINDS.

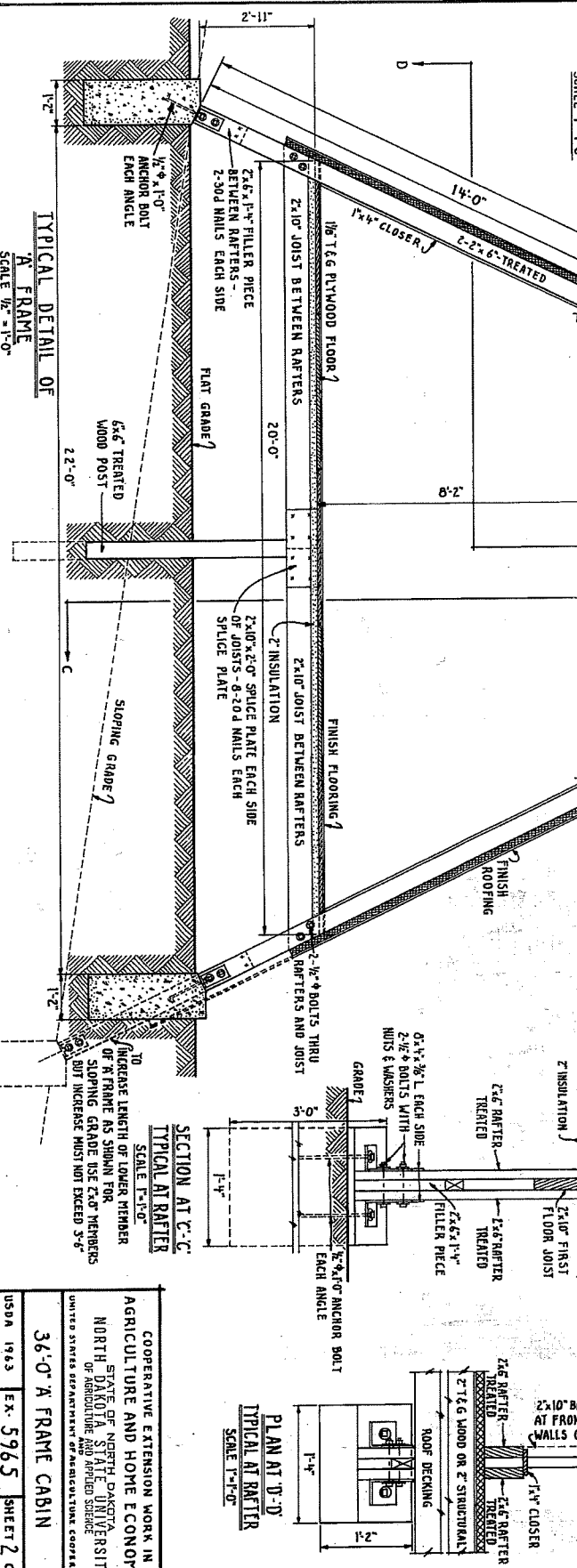
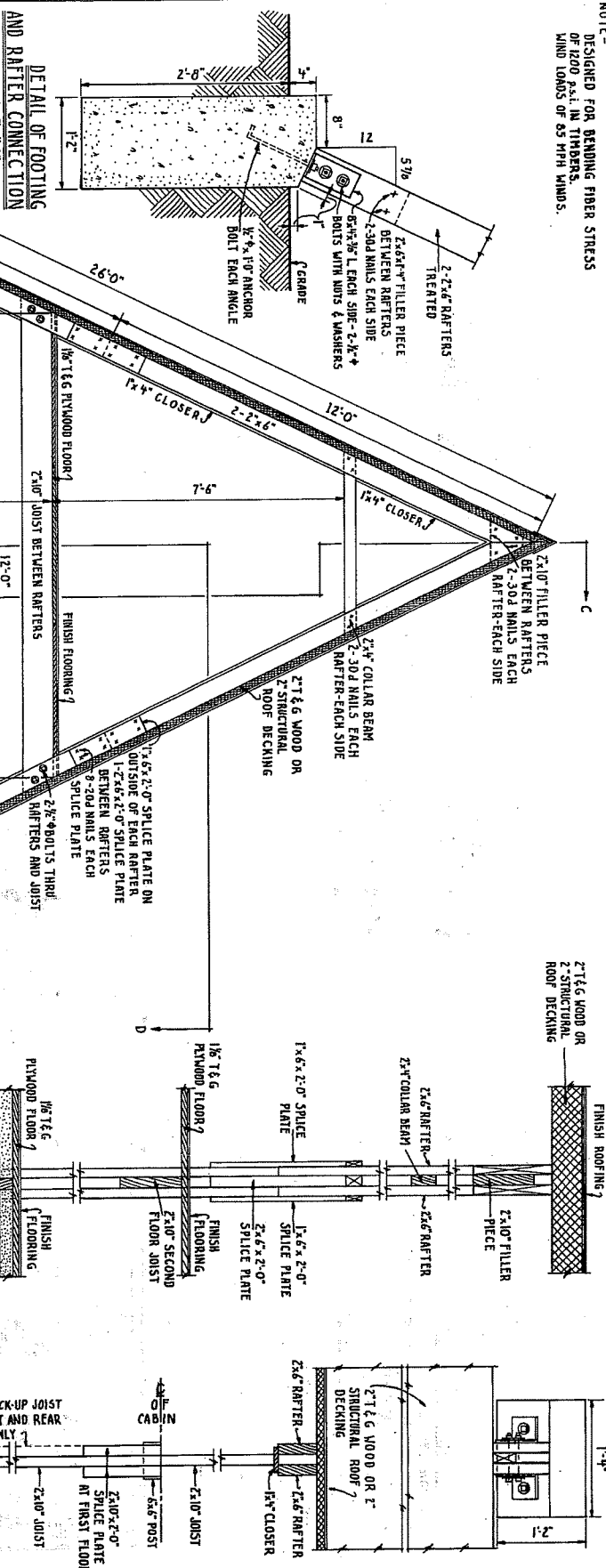

COOPERATIVE EXTENSION WORK IN
AGRICULTURE AND HOME ECONOMICS
STATE OF NORTH DAKOTA
NORTH DAKOTA STATE UNIVERSITY
OF AGRICULTURE AND MECHANICAL ARTS
UNITED STATES DEPARTMENT OF AGRICULTURE COOPERATING

36'-0" A FRAME CABIN
EX-5965 SHEET 2 OF 3

USDA 1963

Drawn by S.E. VII. Checked by G.A. 1/68

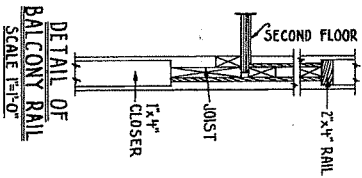
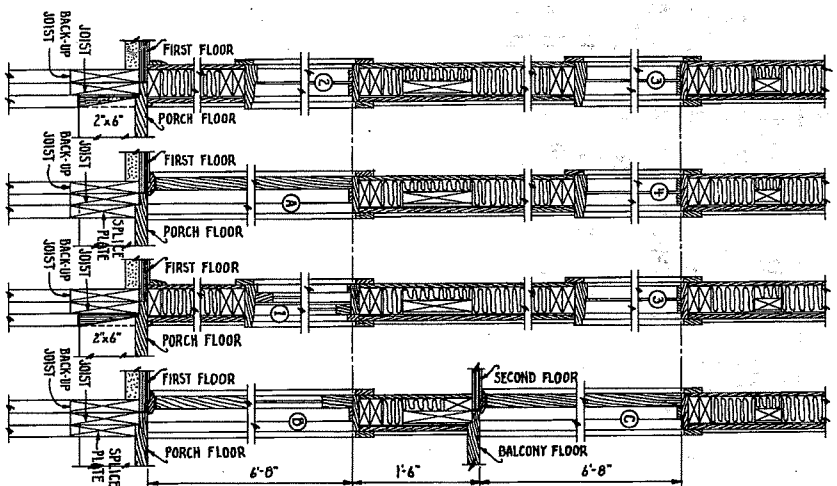
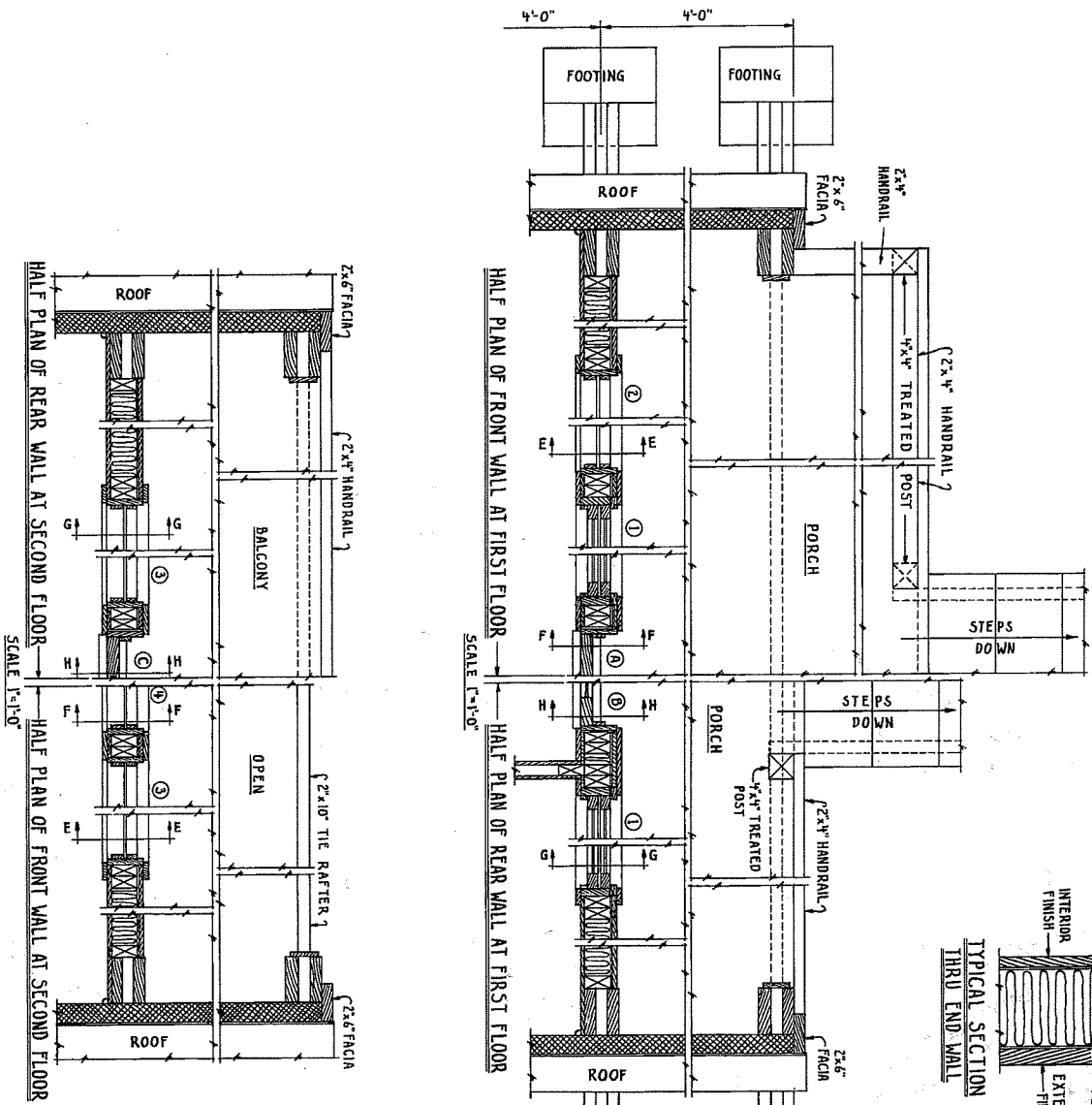

NOTE - PORCH CONSTRUCTION - 2" PLANKING OR 2"x4" FLOORING - 2" O.C.

SECTION FF SECTION FF SECTION GG SECTION HH
 SCALE 1"=1'-0"

COOPERATIVE EXTENSION WORK IN
 AGRICULTURE AND HOME ECONOMICS
 STATE OF NORTH DAKOTA
 NORTH DAKOTA STATE UNIVERSITY
 DEPARTMENT OF AGRICULTURE AND
 HOME ECONOMICS
 UNITED STATES DEPARTMENT OF AGRICULTURE COOPERATING

36-0" A FRAME CABIN

USDA 1963 EX-5965 SHEET 3 OF 3

D. Swafford & Son, Inc. Dickinson, N.D.