

TYPICAL CROSS SECTION

ALL PLYWOOD IS EXTERIOR-TYPE (EXT-DPPL)
 ROOF AND ROOF DOOR PLYWOOD IS 1/2" THICK
 ALL OTHER PLYWOOD IS 3/4" THICK

NOTES:

- ALL FASTENERS SHOULD BE CORROSION RESISTANT OR STAINLESS STEEL.
- NAILS USE 6D NAILS 6" O.C. WHEN NAILING PLYWOOD TO SUPPORTS, ON ENDS OF BINS, 6d @ 6" O.C. (BULKHEADS)
- BULKHEADS ARE TIED TOGETHER WITH 1/2" ROOPS
- THE BIN MAY BE USED ON ANY SUPPORT SYSTEM SUCH AS PIER FOOTINGS, WELL BRACED LESS OR LOW WALLS WITH FOOTINGS.
- EACH OF THE COMPARTMENTS HOLDS 5 TONS OF 60 PCP FERTILIZER
- THIS SHEET SHOWS A THREE COMPARTMENT BIN FOR BMS WITH MORE OR LESS, THE LENGTHS OF SKIDS AND SIDE MEMBERS SHOULD BE ADJUSTED.

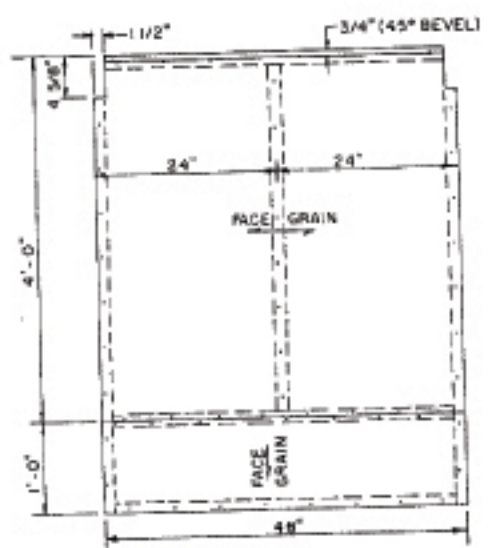

BIN FLOOR DETAIL
 CLOSED SIDE

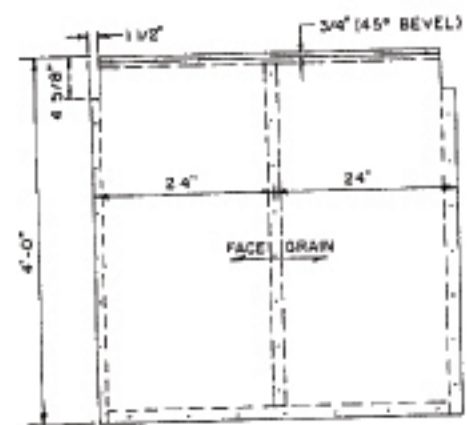

BIN FLOOR DETAIL
 DOOR OPENING SIDE

DESIGNED:
 AMERICAN PLYWOOD ASSOCIATION
 TACOMA, WASHINGTON

COOPERATIVE EXTENSION WORK IN
 AGRICULTURE AND HOME ECONOMICS
 DEPARTMENT OF AGRICULTURAL ENGINEERING
 UNIVERSITY OF MARYLAND
 AND
 UNITED STATES DEPARTMENT OF AGRICULTURE COOPERATING

**TRANSPORTABLE STORAGE BIN
 FOR FERTILIZER IN BULK**

APA	OR	6072	SHEET 1 OF 3
-----	----	------	--------------