

PERSPECTIVE

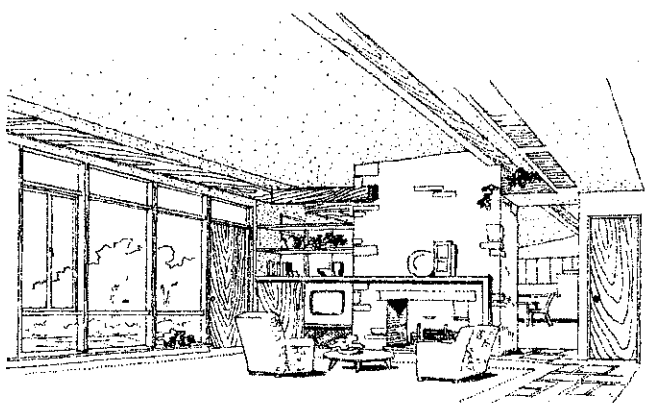

LIVING ROOM INTERIOR

THE TWO-WAY FIREPLACE AND OPEN SHELVES SEPARATE THE LIVING ROOM AND FAMILY ROOM. LARGE WINDOWS AND A SLOPING CEILING GIVE A FEELING OF SPACIOUSNESS.

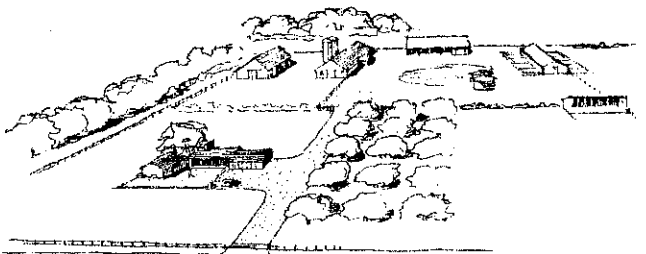

SUGGESTED PLOT PLAN

LOCATE HOUSE SO THAT PREVAILING WINDS DO NOT CARRY ODORS AND DUST FROM LIVESTOCK BUILDINGS AND YARDS TO THE HOUSE, WHICH SHOULD BE KEPT ABOUT 100 FEET FROM THE FARM COURT.

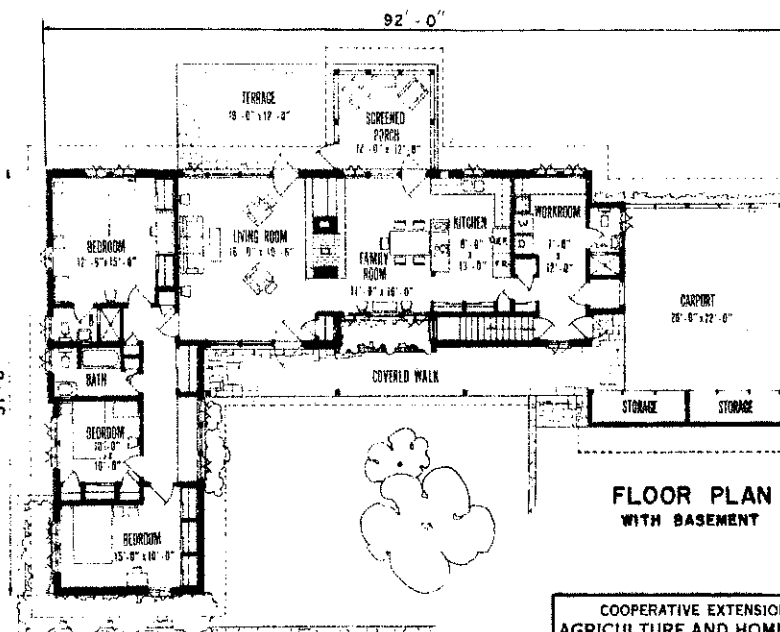

SQUARE FOOT AREA

HOUSE	2090 SQ. FT.
PORCHES & TERRACES	718 SQ. FT.
CARPENT & STORAGE	570 SQ. FT.
TOTAL	3378 SQ. FT.

COOPERATIVE EXTENSION WORK IN AGRICULTURE AND HOME ECONOMICS

STATE OF NORTH DAKOTA
NORTH DAKOTA STATE UNIVERSITY
OF AGRICULTURE AND MECHANICAL SCIENCE

AND
UNITED STATES DEPARTMENT OF AGRICULTURE COOPERATING

3 BEDROOM FARMHOUSE

USDA 57 EX. 7131 SHEET 1 OF 6

Revised 1938

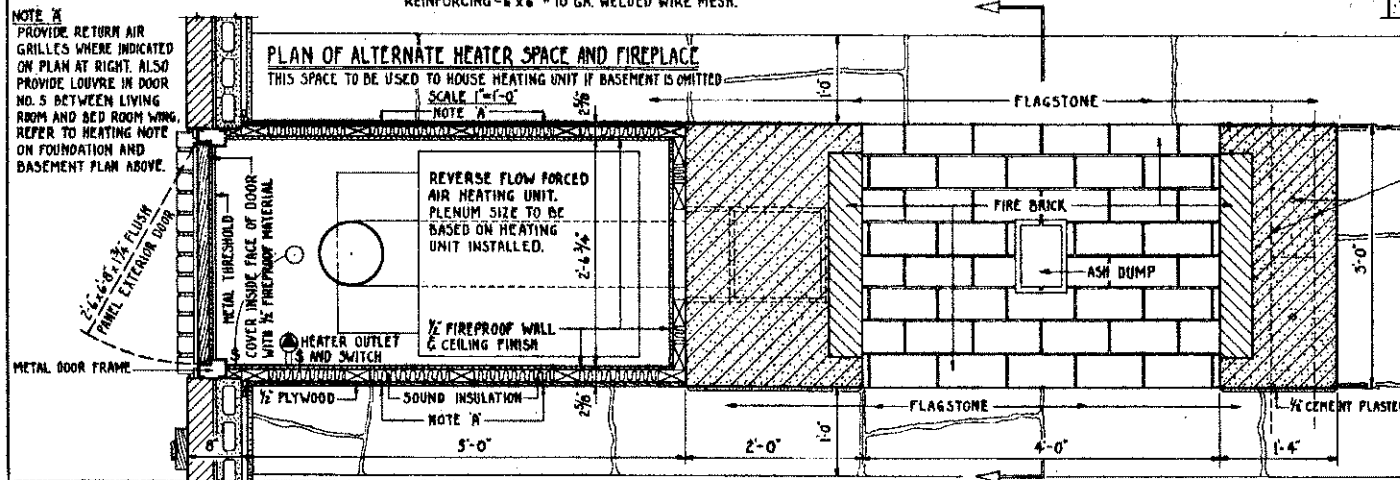
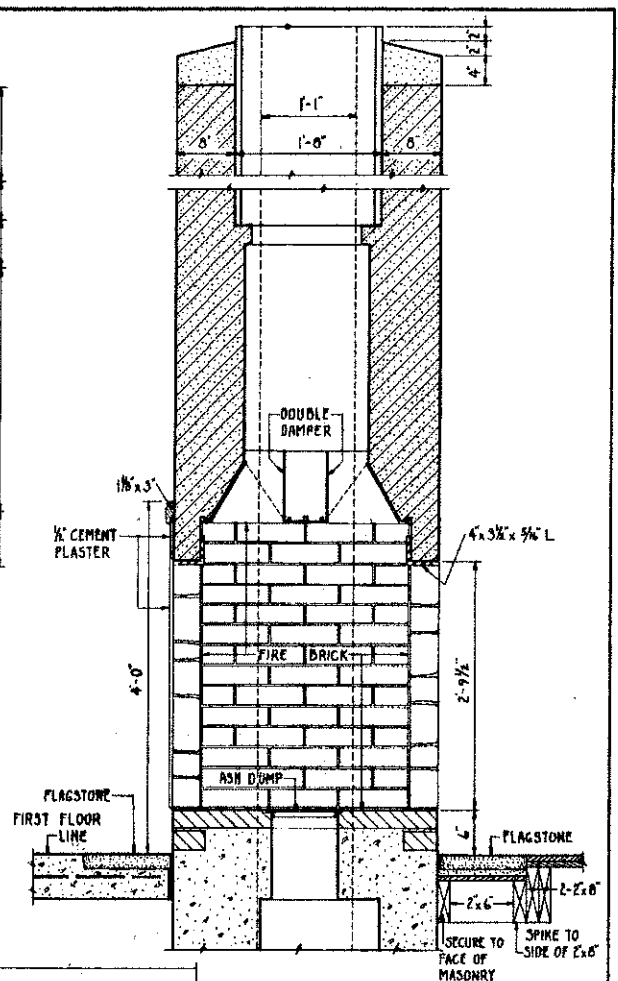
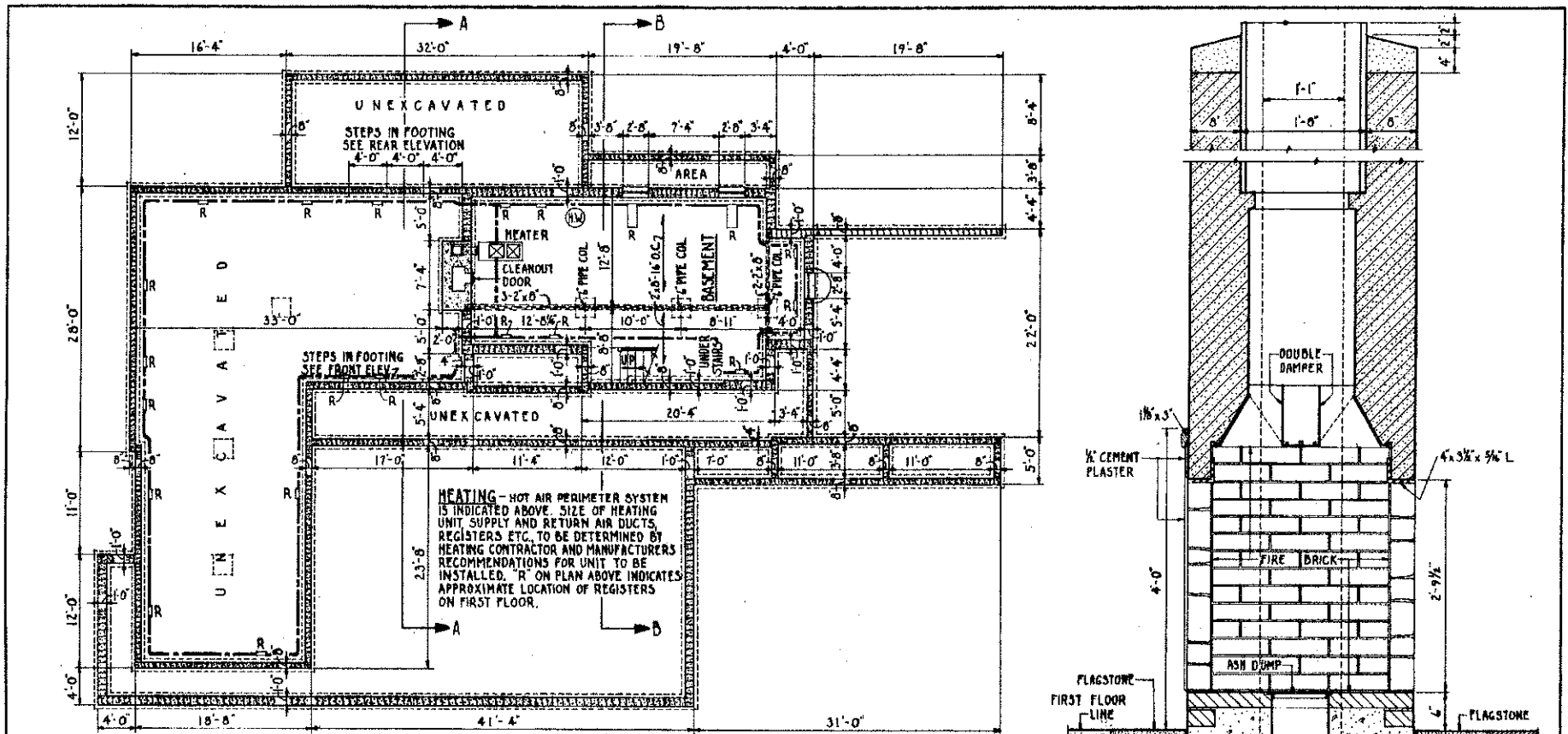

SECTION THRU FIREPLACE & CHIMNEY
SCALE 1" = 1'-0"

DOTTED LINES INDICATE LOCATION OF 4"x4" RIDGE SECTIONS WHERE THEY REST ON CHIMNEY MASONRY AND LOCATION OF 3/4" x 5'-0" LONG ANCHOR BOLTS. ALSO SEE SECTION A-A AND TYPICAL RIDGE DETAIL ON SHEET 5 OF 6.

REV. JAN. 1958

COOPERATIVE EXTENSION WORK IN
AGRICULTURE AND HOME ECONOMICS

STATE OF NORTH DAKOTA
NORTH DAKOTA STATE UNIVERSITY
OF AGRICULTURE AND APPLIED SCIENCE
AND
UNITED STATES DEPARTMENT OF AGRICULTURE COOPERATING

3 BEDROOM FARMHOUSE

U.S.B.A. '36 EX. 7131 SHEET 2 OF 6

FOUNDATION & BASEMENT PLAN - FIREPLACE DETAILS

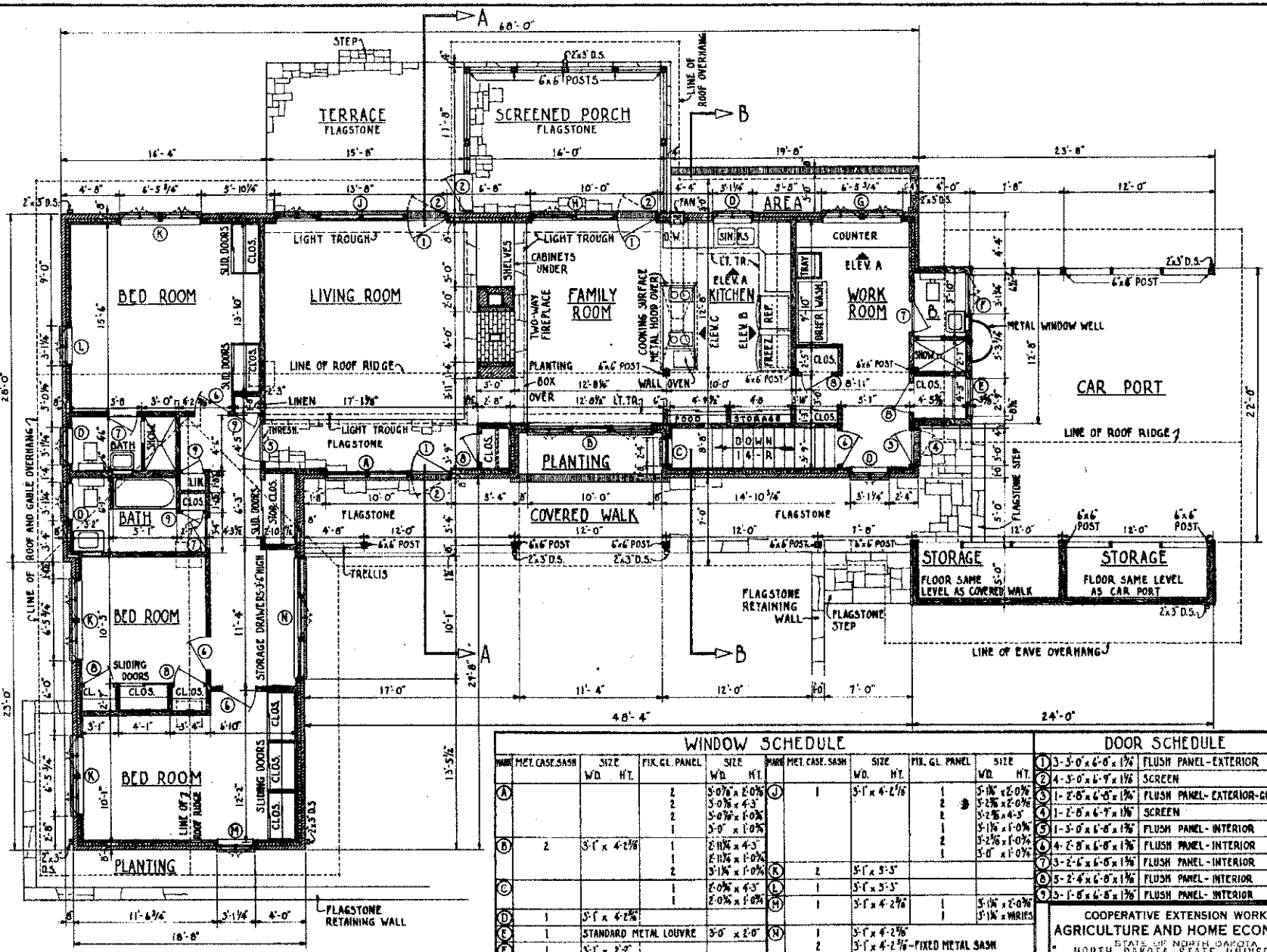

FIRST FLOOR PLAN

SCALE 3/16" = 1'-0"

NOTE - IF BASEMENT IS OMITTED SPACE NOW OCCUPIED BY STAIRWAY TO BE USED FOR STORAGE.

WINDOW SCHEDULE

NO.	MET. CASE	SASH	SIZE	FIX. GL. PANEL	SIZE	NO.	MET. CASE	SASH	SIZE	FIX. GL. PANEL	SIZE
			WD. HT.		WD. HT.				WD. HT.		WD. HT.
A			3'-0" x 2'-0"	2	3'-0" x 4'-3"	1			3'-1" x 4'-2 1/2"		
B	2		3'-1" x 4'-2 1/2"	1	2'-11" x 4'-3"	2			3'-1" x 3'-3"		
C			2'-0" x 4'-3"	1	2'-0" x 1'-0"	L	2		3'-1" x 3'-3"		
D	1		3'-1" x 4'-2 1/2"	1	2'-0" x 4'-3"	M	1		3'-1" x 4'-2 1/2"	1	3'-1 1/4" x 2'-0 1/2"
E	1	STANDARD METAL LOUVRE	3'-0" x 2'-0"		2'-0" x 1'-0"	N	1		3'-1" x 4'-2 1/2"		
F	1		3'-1" x 2'-2"		2'-0" x 1'-0"	P	3	2'-0" x 1'-10"	MET. BASEMENT SASH		
G	2		3'-1" x 4'-2 1/2"	1	3'-1 1/4" x 2'-0 1/2"						
H	1		3'-1" x 4'-2 1/2"	1	3'-0" x 2'-0"						
				1	3'-0" x 4'-3"						
				1	3'-1 1/4" x 1'-0"						
				1	3'-0" x 1'-0"						
				1	3'-0" x 1'-0"						
				1	3'-0" x 1'-0"						

DOOR SCHEDULE

1	3'-3 1/2" x 6'-0" x 1 1/2"	FLUSH PANEL - EXTERIOR
2	4'-3 1/2" x 6'-9" x 1 1/2"	SCREEN
3	1'-2 1/2" x 6'-0" x 1 1/2"	FLUSH PANEL - EXTERIOR-GLAZED
4	1'-2 1/2" x 6'-9" x 1 1/2"	SCREEN
5	1'-3 1/2" x 6'-0" x 1 1/2"	FLUSH PANEL - INTERIOR
6	4'-2 1/2" x 6'-0" x 1 1/2"	FLUSH PANEL - INTERIOR
7	3'-2 1/2" x 6'-0" x 1 1/2"	FLUSH PANEL - INTERIOR
8	5'-2 1/2" x 6'-0" x 1 1/2"	FLUSH PANEL - INTERIOR
9	3'-1 1/2" x 6'-0" x 1 1/2"	FLUSH PANEL - INTERIOR

COOPERATIVE EXTENSION WORK IN AGRICULTURE AND HOME ECONOMICS
 STATE OF NORTH DAKOTA
 NORTH DAKOTA STATE UNIVERSITY
 DEPARTMENT OF AGRICULTURE AND APPLIED SCIENCE
 AND
 UNITED STATES DEPARTMENT OF AGRICULTURE COOPERATING

3 BEDROOM FARMHOUSE

U.S.D.A. '34 EX. 7131 SHEET 3 OF 6

REVISED JANUARY 1959
 REVISED JANUARY 1957

FIRST FLOOR PLAN - WINDOW & DOOR SCHEDULES

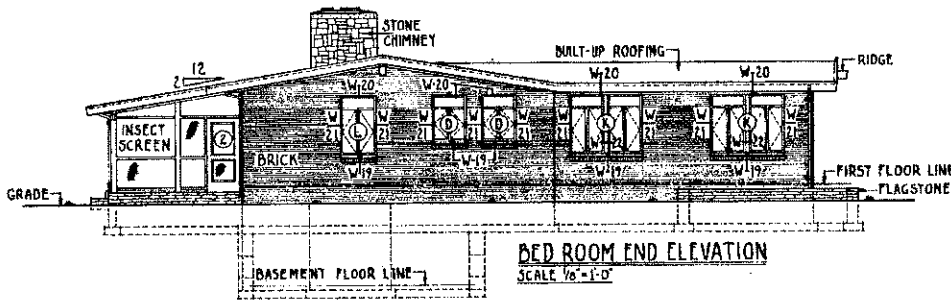

BED ROOM END ELEVATION
SCALE 1/8" = 1'-0"

ELECTRICAL KEY	
HO 1	HEATER OUTLET & SWITCH
HO 2	HOT WATER HEATER OUTLET
HO 3	WALL OVEN OUTLET
HO 4	COOKING SURFACE OUTLET
HO 5	DISHWASHER OUTLET
HO 6	REFRIGERATOR & FREEZER OUTLET
HO 7	WASHER & DRIER OUTLETS
HO 8	RADIO AND/OR TELEVISION OUTLET
HO 9	WEATHER PROOF OUTLET
LF 1	LIGHT FIXTURE WITH PULL SWITCH
SW	SWITCH FOR HEATING UNIT
—	SINGLE TUBE FLUORESCENT FIXTURE
HO F	EXHAUST FAN OUTLET & SWITCH
HO 2	SPLIT-WIRED OUTLET-3 WIRE-120/240 V
FO	FLOOR OUTLET
PB	PUSH BUTTON
CH	CHINES

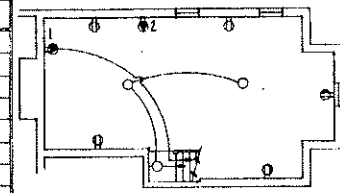

BASEMENT ELECTRICAL LAYOUT

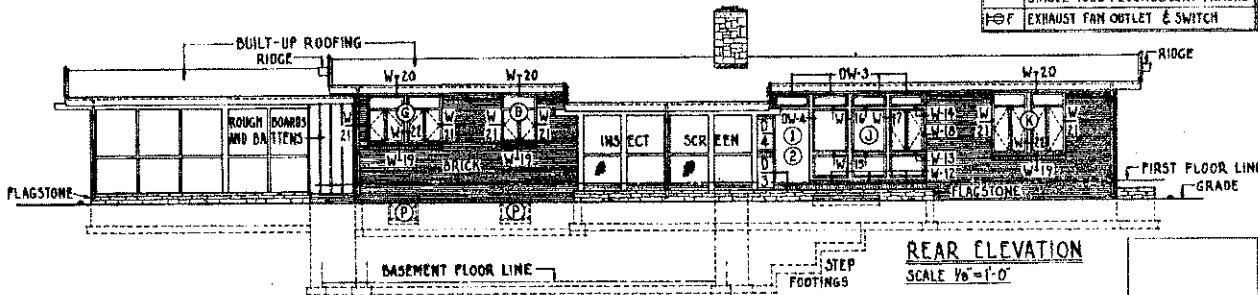

REAR ELEVATION
SCALE 1/8" = 1'-0"

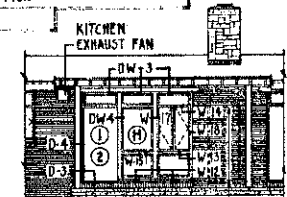

ELEVATION OPENING
SCALE 1/8" = 1'-0"

DOTTED LINES INDICATE ACCESS DOOR TO ALTERNATE HEATER ROOM WHEN HOUSE IS BUILT WITHOUT BASEMENT

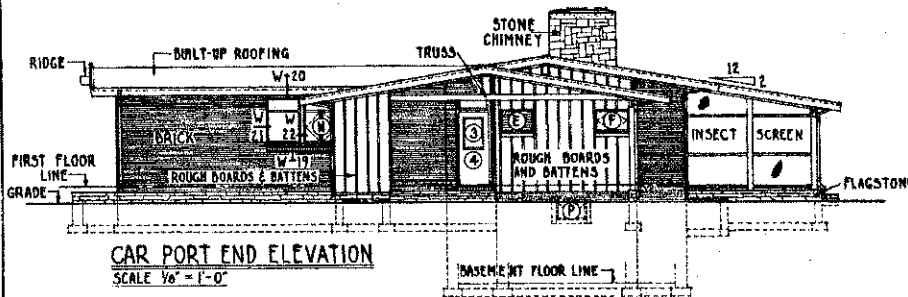

CAR PORT END ELEVATION
SCALE 1/8" = 1'-0"

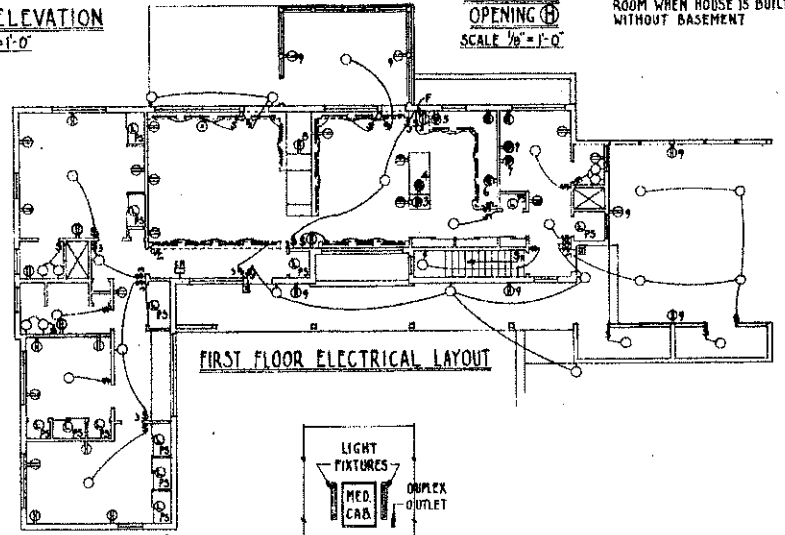

FIRST FLOOR ELECTRICAL LAYOUT

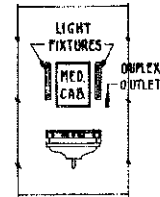

TYPICAL ELEVATION BATHROOM LIGHTING OVER LAVATORY

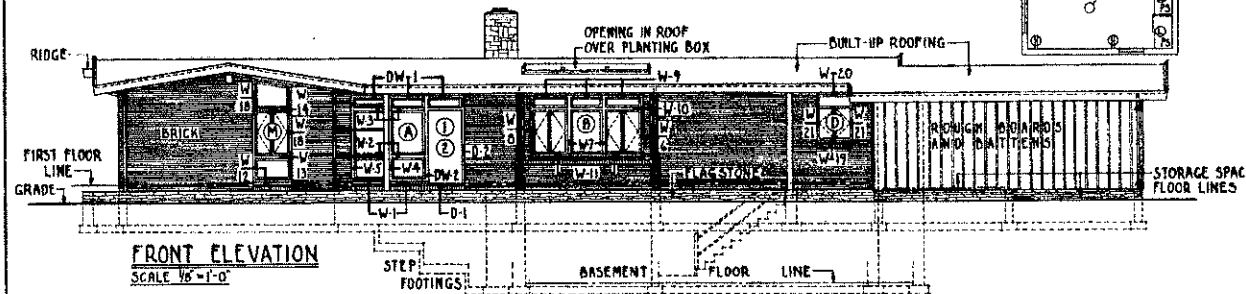

FRONT ELEVATION
SCALE 1/8" = 1'-0"

COOPERATIVE EXTENSION WORK IN AGRICULTURE AND HOME ECONOMICS
STATE OF NORTH DAKOTA
NORTH DAKOTA STATE UNIVERSITY
OF AGRICULTURE AND APPLIED SCIENCE
AND
UNITED STATES DEPARTMENT OF AGRICULTURE COOPERATING

3 BEDROOM FARMHOUSE

U.S.O.A. '54 EX. 7131 SHEET 4 OF 6

ELEVATIONS - ELECTRICAL LAYOUTS

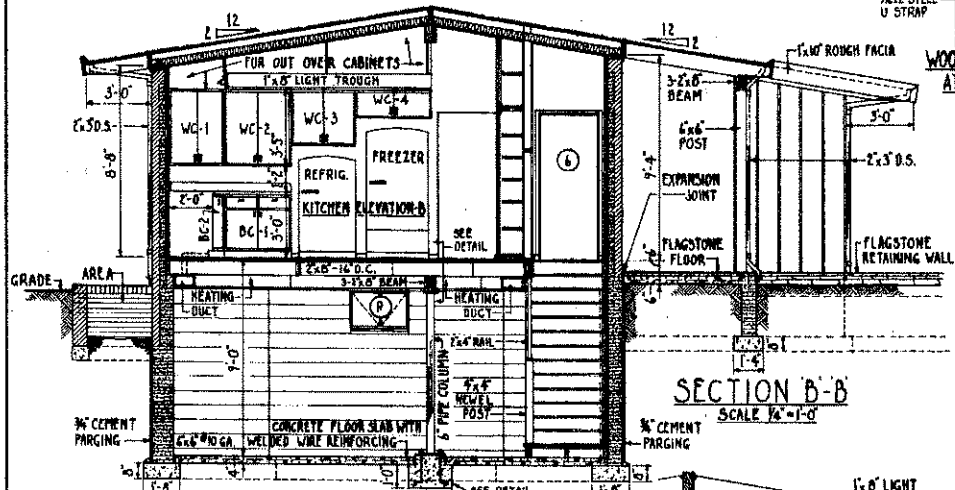
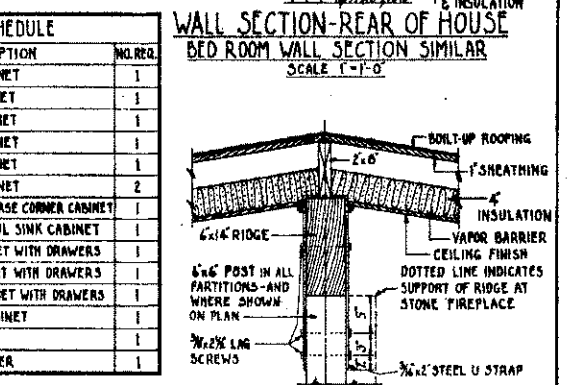
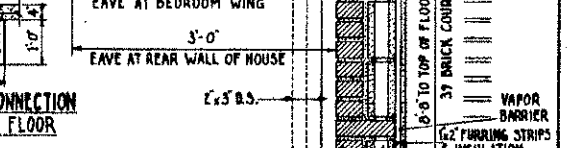
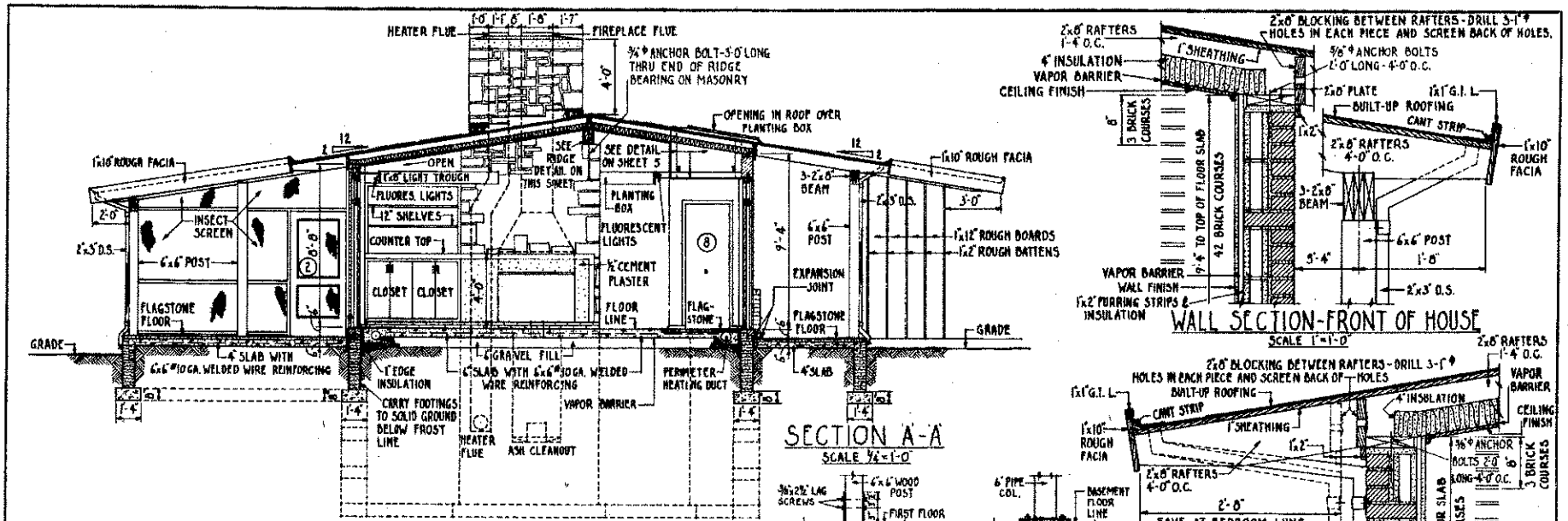

KITCHEN CABINET SCHEDULE

MARK	SIZE	DESCRIPTION	NO. REQ.
WC-1	36"W-15'D-4'1"H	STANDARD WALL CABINET	1
WC-2	36"W-15'D-4'1"H	STANDARD WALL CABINET	1
WC-3	36"W-15'D-3'0"H	STANDARD WALL CABINET	1
WC-4	42"W-13'D-1'5"H	STANDARD WALL CABINET	1
WC-5	36"W-13'D-2'4"H	STANDARD WALL CABINET	1
BC-1	36"W-2'0"-3'6"H	STANDARD BASE CABINET	2
BC-2	30"W-3'0"-3'6"H	STANDARD REVOLVING BASE CORNER CABINET	1
BC-3	42"W-2'4"-3'6"H	STANDARD DOUBLE BOWL SINK CABINET	1
BC-4	2'4"W-2'4"-3'6"H	STANDARD BASE CABINET WITH DRAWERS	1
BC-5	3'6"W-2'4"-3'6"H	STANDARD BASE CABINET WITH DRAWERS	1
BC-6	2'4"W-3'0"-3'6"H	STANDARD RANGE CABINET WITH DRAWERS	1
BC-7	3'0"W-3'0"-3'6"H	STANDARD RANGE CABINET	1
O-1	2'4"W-3'0"-3'6"H	STANDARD OVEN UNIT	1
DW-1	2'4"W-2'4"-3'6"H	STANDARD DISH WASHER	1

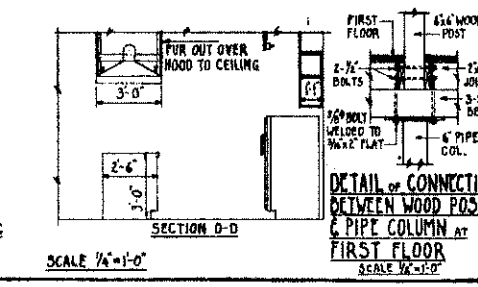
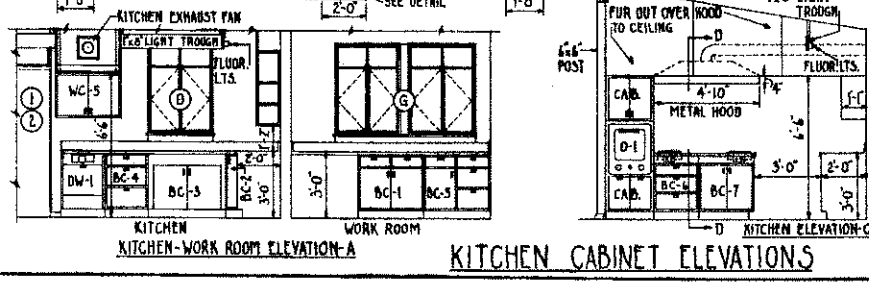
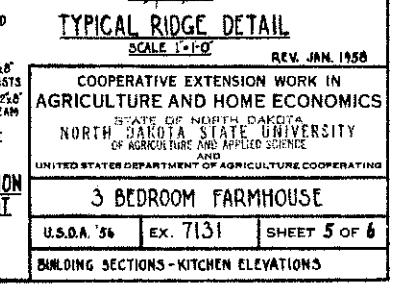

REV. JAN. 1958

COOPERATIVE EXTENSION WORK IN AGRICULTURE AND HOME ECONOMICS

STATE OF NORTH DAKOTA
NORTH DAKOTA STATE UNIVERSITY
OF AGRICULTURE AND APPLIED SCIENCE

UNITED STATES DEPARTMENT OF AGRICULTURE COOPERATING

3 BEDROOM FARMHOUSE

U.S.D.A. 36 EX. 7131 SHEET 5 OF 6

BUILDING SECTIONS-KITCHEN ELEVATIONS

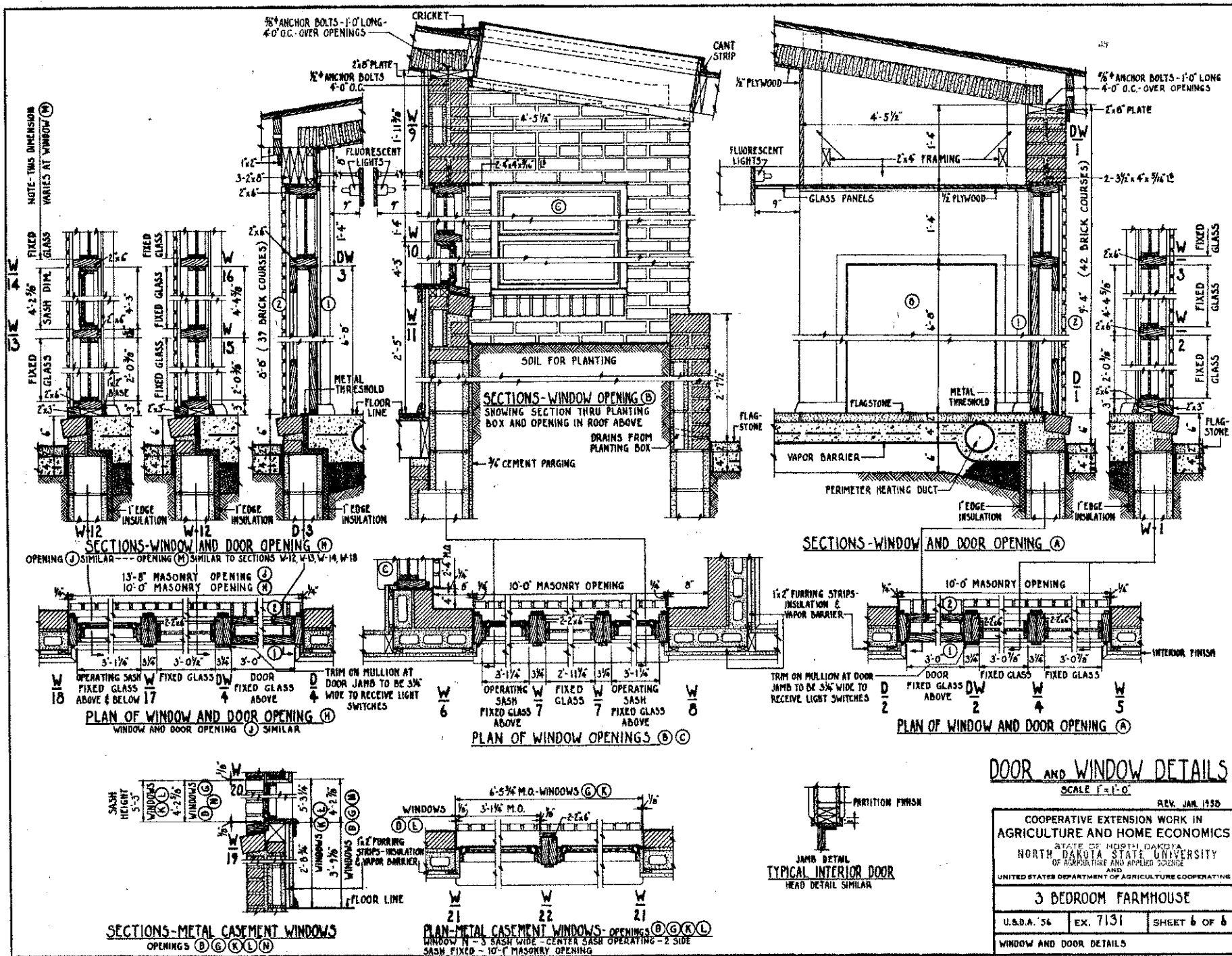

DOOR AND WINDOW DETAILS
SCALE 1"=1'-0"

REV. JAN. 1950

COOPERATIVE EXTENSION WORK IN AGRICULTURE AND HOME ECONOMICS
STATE OF NORTH DAKOTA
NORTH DAKOTA STATE UNIVERSITY
OF AGRICULTURE AND APPLIED SCIENCE
AND
UNITED STATES DEPARTMENT OF AGRICULTURE COOPERATING

3 BEDROOM FARMHOUSE

U.S.D.A. '54	EX. 7131	SHEET 6 OF 6
--------------	----------	--------------

WINDOW AND DOOR DETAILS