

BATTER BOARDS & STAKES

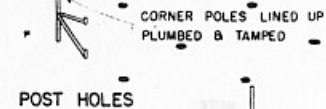

POST HOLES

2" X 6" TEMPORARY GIRT MAY BE REMOVED AFTER RAFTERS ARE IN PLACE

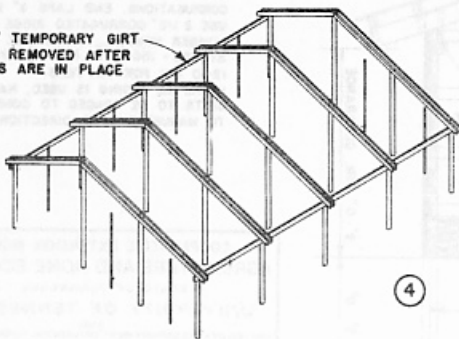

ERECTION OF BALANCE OF POLES & RAFTERS

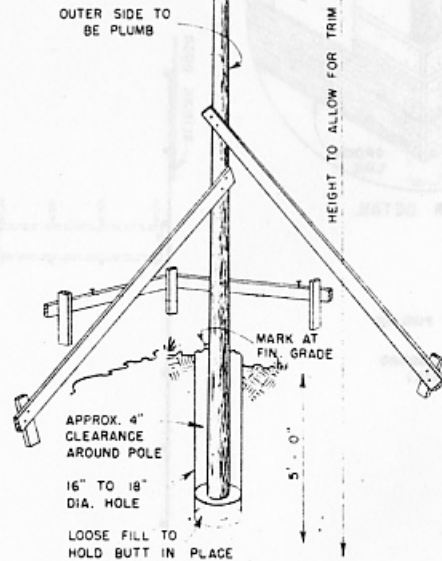

POST HOLE & BRACED POLE

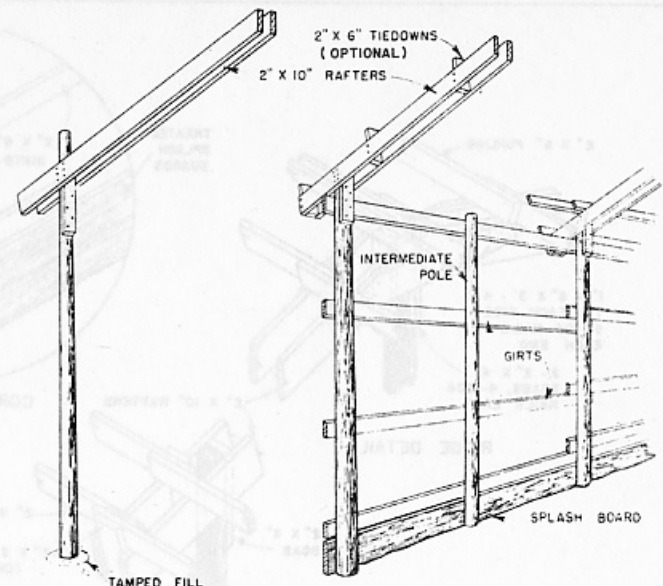

POLES, RAFTERS, PURLINS & GIRTS

NOTE  
ALL POLES & SPLASH BOARDS TO BE PRESSURE-TREATED WITH PRESERVATIVE.

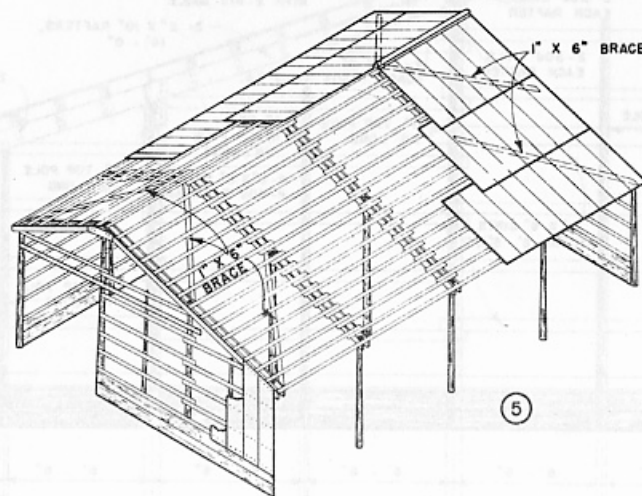

PURLINS, GIRTS, ROOFING & SIDING

NOTE

THIS BUILDING IS DESIGNED FOR AREAS OF THE SOUTHERN UNITED STATES WHERE THE SNOW LOAD DOES NOT EXCEED 10" PER SQ. FT. & WIND DOES NOT EXCEED 88 MI. PER HOUR. IN A FEW AREAS, SUCH AS NORTHERN VIRGINIA & WESTERN KENTUCKY WHERE SNOW LOADS EXCEED 10" PER SQ. FT., 2" X 12" RAFTERS SHOULD BE USED INSTEAD OF THE 2" X 10" RAFTERS SHOWN & PURLINS SHOULD BE SPACED 16" O.C. INCREASE NUMBER OF 30d NAILS IN RAFTER TO POLE CONNECTIONS 50%. IT SHOULD NOT BE USED IN OTHER AREAS WITHOUT REDESIGNING FRAMING TO MEET LOCAL CONDITIONS.

NOTE

THIS BARN MAY BE BUILT IN ANY LENGTH DESIRED IN UNITS OF 15'-0".

COOPERATIVE EXTENSION WORK IN  
AGRICULTURE AND HOME ECONOMICS  
STATE OF TENNESSEE  
**UNIVERSITY OF TENNESSEE**  
UNITED STATES DEPARTMENT OF AGRICULTURE

POLE BARN

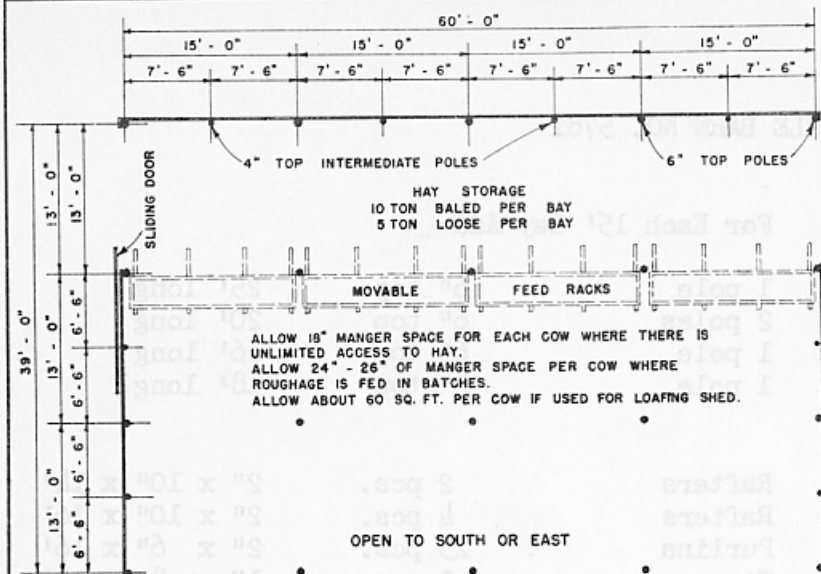

FLOOR PLAN

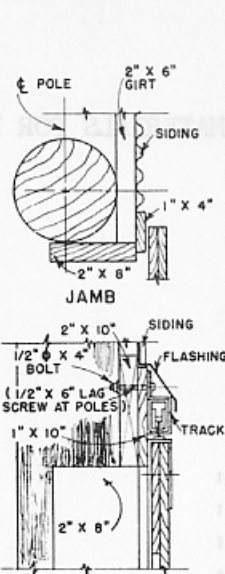

HEAD  
DOOR DETAIL

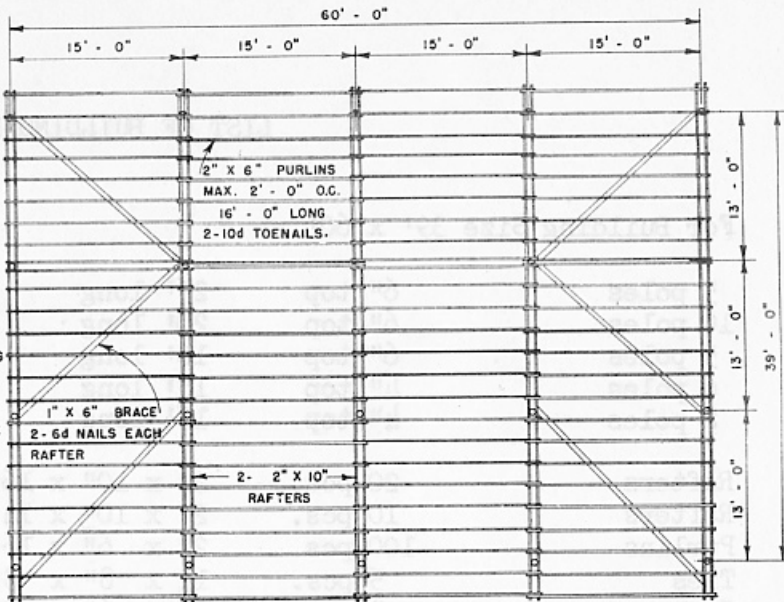

ROOF FRAMING PLAN

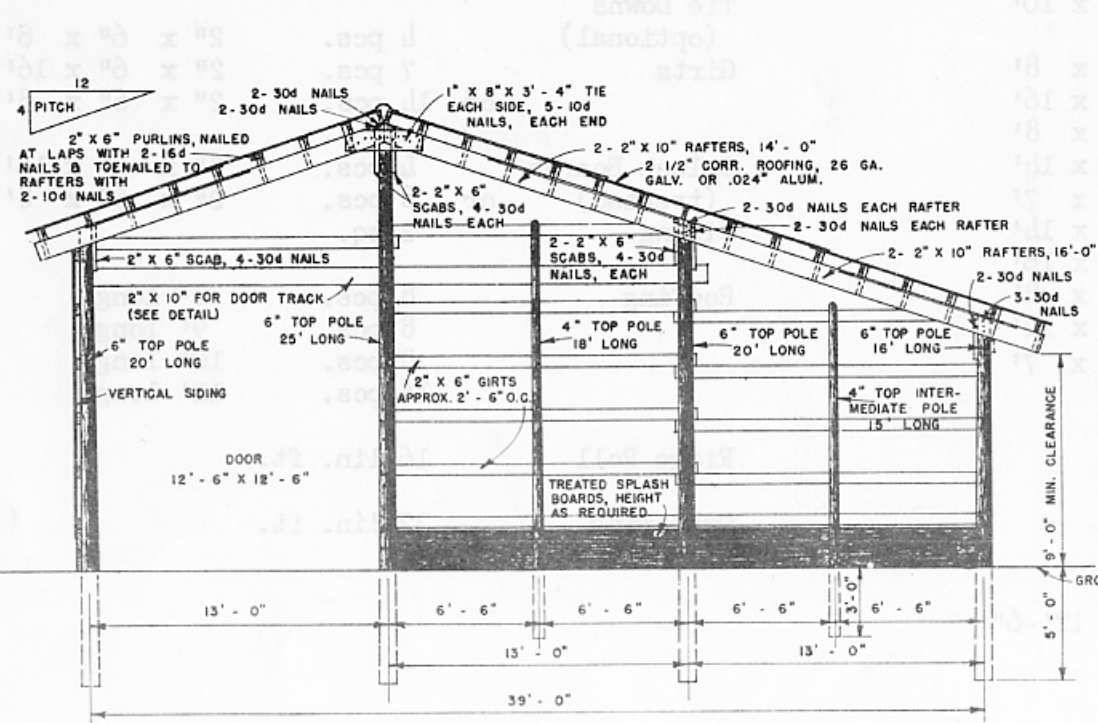

CROSS SECTION SHOWING END WALL FRAMING

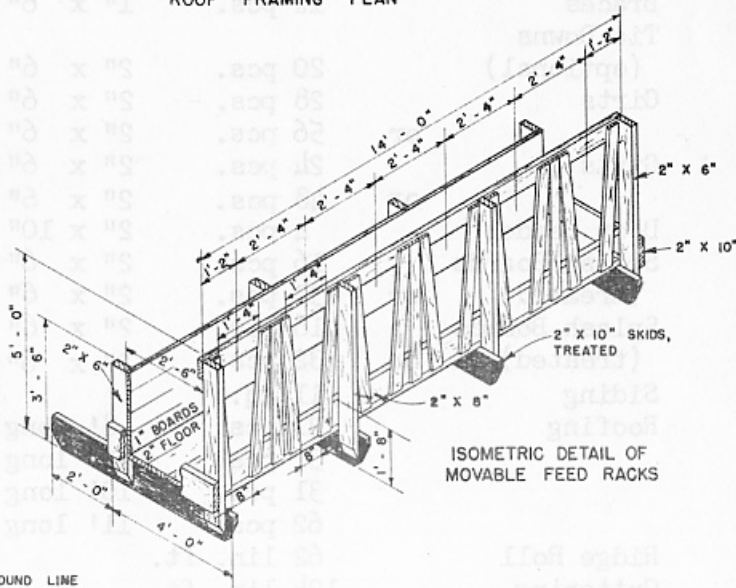

ISOMETRIC DETAIL OF  
MOVABLE FEED RACKS

NOTE:  
IF IN THE FUTURE THIS BARN IS TO BE  
WIDENED TO 52' AS SHOWN ON SHEET  
3, USE LONGER POLES AS SHOWN ON  
SHEET 3.

COOPERATIVE EXTENSION WORK IN  
AGRICULTURE AND HOME ECONOMICS  
STATE OF TENNESSEE  
UNIVERSITY OF TENNESSEE  
AND  
UNITED STATES DEPARTMENT OF AGRICULTURE COOPERATING

**POLE BARN 39' WIDE**

USDA '54 EX. 5781 SHEET 2 OF 3

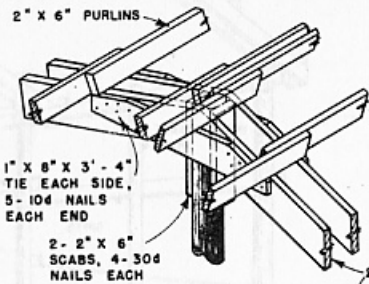

RIDGE DETAIL

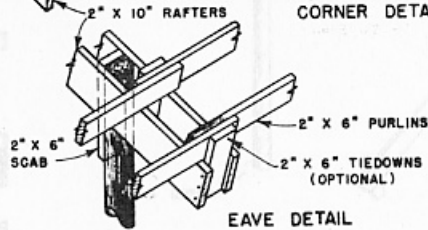

EAVE DETAIL

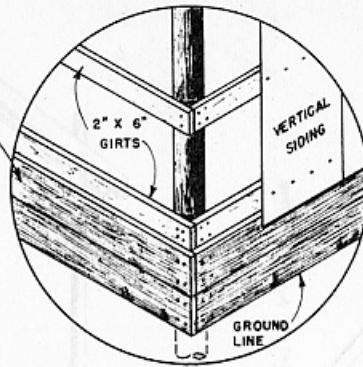

CORNER DETAIL

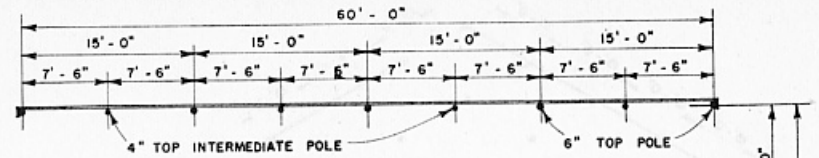

FLOOR PLAN

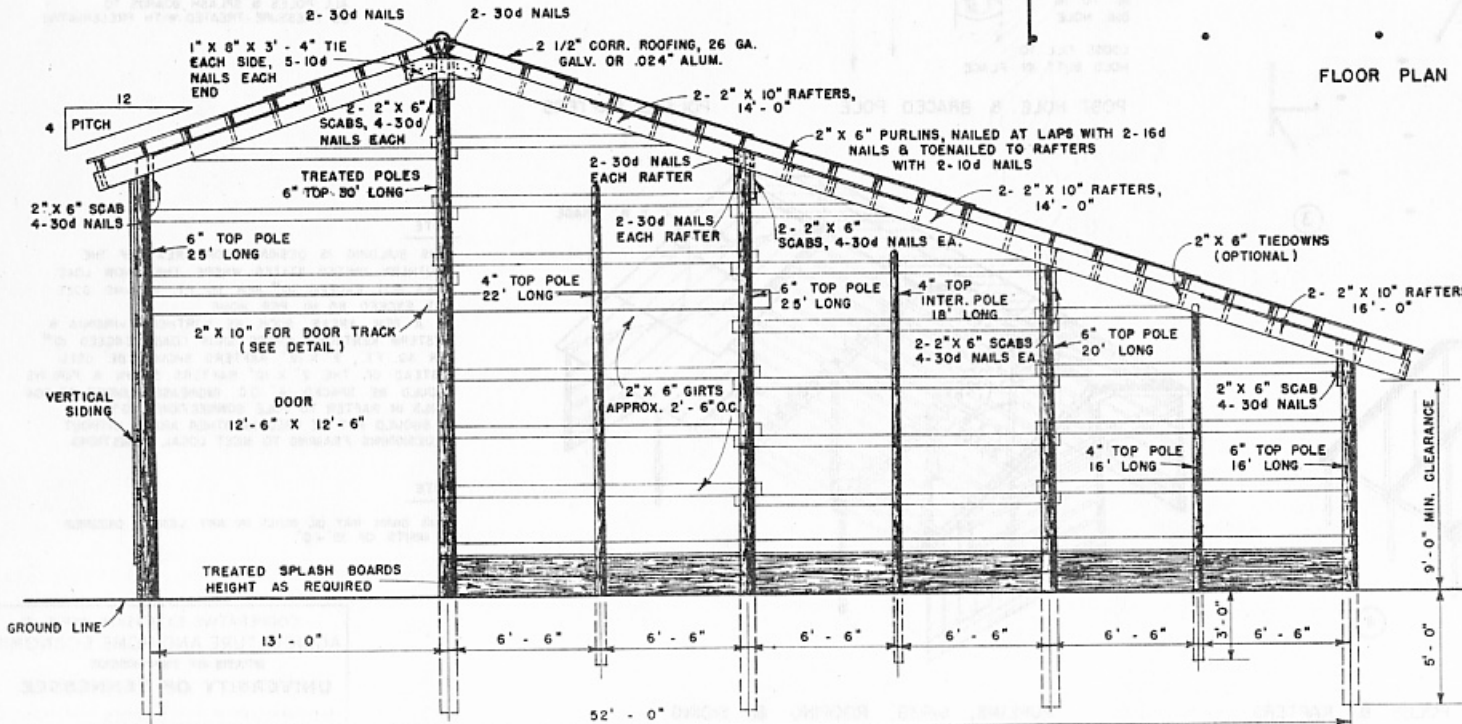

CROSS SECTION SHOWING END WALL FRAMING

NOTE:

ROOFING - PURLIN SPACING NOT TO EXCEED 2' - 0" FOR .024", 2 1/2" CORRUGATED ALUM. OR 26 GA. 2 1/2" CORRUGATED GALVANIZED STEEL. SIDE LAP SHEETS AT LEAST 1 1/2" CORRUGATIONS, END LAPS 6" MIN. USE 2 1/2" CORRUGATED RIDGE ROLL. LUMBER NOMINAL, ALLOWABLE FIBER STRESS - 1500 PSI FOR PURLINS, 1200 PSI FOR RAFTERS. IF METAL SIDING IS USED, NAILING GIRTS TO BE SPACED TO CONFORM TO MANUFACTURERS DIRECTIONS.

COOPERATIVE EXTENSION WORK IN AGRICULTURE AND HOME ECONOMICS  
STATE OF TENNESSEE  
UNIVERSITY OF TENNESSEE  
AND  
UNITED STATES DEPARTMENT OF AGRICULTURE COOPERATING

POLE BARN 52' WIDE

USDA '54 EX. 5781 SHEET 3 OF 3