

# MWPS-72666

## Farrowing House

Single Row.

### **CAUTION!**

Additional professional services will be required to tailor this plan to your situation, including but not limited to: assurance of compliance with codes and regulations; review of specifications for materials and equipment; supervision of site selection, bid letting and construction; and provision for utilities, waste management, roads or other access. **Furthermore, any deviation from the given specifications may result in structural failure, property damage, and personal injury including loss of life.**

### **WARRANTY DISCLAIMER**

This plan provides conceptual information only. **Neither midwest plan service nor any of the cooperating land-grant universities, or their respective agents or employees, have made, and do not hereby make, any representation, warranty or covenant with respect to the specifications in this plan.** Additional professional services will be required to tailor this plan to your situation, including but not limited to: assurance of compliance with codes and regulations; review of specifications for materials and equipment; supervision of site selection, bid letting and construction; and provision for utilities, waste management, roads or other access.

<b>MIDWEST PLAN SERVICE</b>
Cooperative Extension Work in Agriculture and Home Economics and Agricultural Experiment Stations of North Central Region - USDA Cooperating
Farrowing House Single Row
Title Page
MIDWEST PLAN NO. 72666

### VENTILATION

#### Winter

Close insulated panels. Thermostat starts fan at low speed at indoor temperatures above 35°F and at high speed above 60°F. Use 2-speed fan--650 cfm at high speed.

Adjust damper manually during winter months so fan operates about one third of the time. Open upper door in fan duct during warmer days (above 40°F.).

#### Summer

During mild weather, operate fan, and open insulated panels along alley. During hot weather (above 75°F) open all panels and doors; fan may be disconnected. Close doors and some panels during storms and cool nights, especially when pigs are young.

Fans: Provide hood and backdraft louver. Use totally-enclosed fan motor with overload protection.

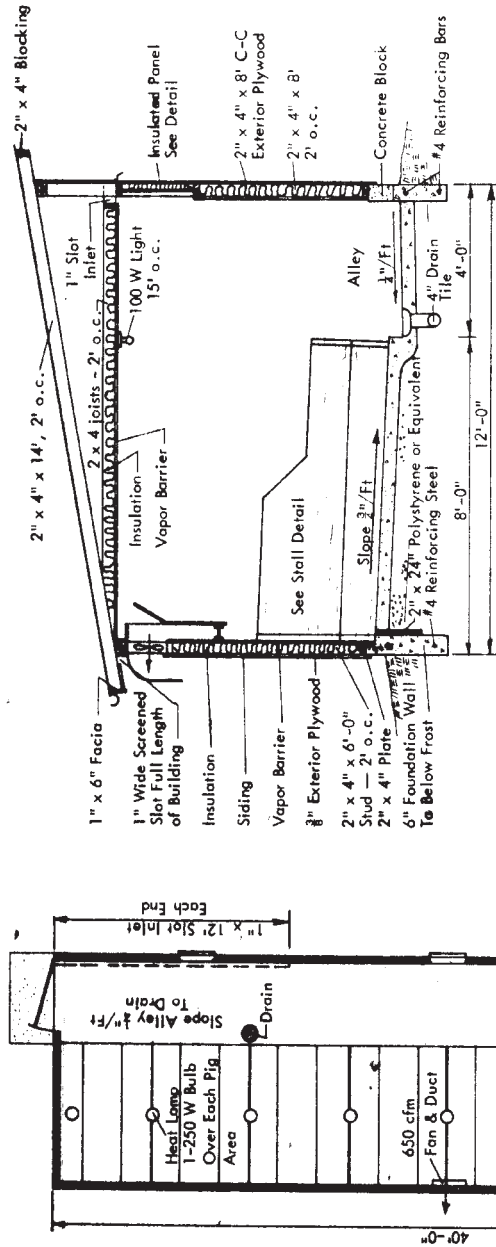

ESTIMATING LIST 72666

Foundation and floors:	11
Concrete, cubic yards	208
Reinforcement, #4 bars, feet	104
Walls, linear feet:	684
Approx. bd. ft. framing	728
Walls, square feet:	12
Less: doors	40
Net, square feet	676
Ceilings, square feet:	480
Roof, squares:	5½
Building length, feet:	40
Rafters, #2 spacing	328
Approx. bd. ft.	

Additional costs:  
 Site preparation, access roads, fencing, etc.  
 Water, gas, electricity brought to site.  
 Pens, stalls, partitions, hardware.  
 Feeders and waterers, and distribution systems.  
 Waste disposal equipment.  
 Electrical system -- lights, outlets, motors.  
 Ventilation -- fans, ducts, louvers, controls.

### HOW TO USE THIS PLAN

These details provide a guide for remodeling an existing building, or for improving present farrowing facilities.

Alternate ventilation systems and construction details for auxiliary equipment are in Swine Equipment Plans and Housing Needs, available at your County Extension Office.

**MIDWEST PLAN SERVICE**  
 Cooperative Extension Work in  
 Agriculture and Home Economics  
 and Agricultural Experiment Stations  
 of North Central Region, USDA, cooperating

**FARROWING HOUSE**  
 Single Row

MIDWEST PLAN NO. **72666**  
 Sheet 1 of 1 Sheets

Copyright © 1967/Midwest Plan Service